

# ITH - Xmas Star



Digital  
files

16x16  
20x30

-----  
6x10"  
8x12"

.PES  
.DST  
.VP3  
.JEF  
.XXX  
.HUS  
.EXP

#### WHAT IS NEEDED:

Padding 1 cm

Foam 1 cm

Felt or fabric of your choice



I put the stabilizer in the frame, I use plastic sheets that have the same characteristics as the water soluble, and it manages to stabilize in an excellent way.  
I embroider the position trace, then place the foam on top of it, about 1 cm high, embroider the next trace and cut out the whole shape.  
The cutout must be very neat and close to the seam which is done in a tight zigzag, so that the stitches cannot be cut.  
I proceed in the same way with the padding layer  
I place the felt rectangle on top and embroider the next trace, I proceed with the quilt embroidery



Then I turn the frame over and place a rectangle of fabric on the back will be the lining. I fix it with pins, I embroider the next line, I cut out the excess of fabric and finish with the cover stitch.  
I do the same procedure for the other side of the star



For both the house and the star I proceed as above, but using only the foam layer

On the shape I go to place pieces of fabric and proceed to perform all the applications, I recommend to perform one step at a time and to cut out precisely each application without leaving any fabric edges

Then I turn the frame over and place a rectangle of fabric on the back will be the lining. I fix it with pins, I embroider the next line, I cut out the excess of fabric and finish with the cover stitch.



No stuffing is needed for the leaf branches and flowers and proceed as above

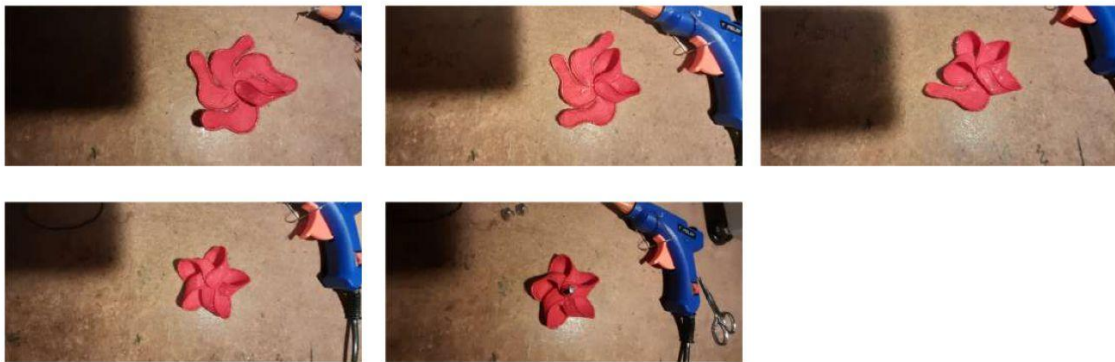

To make the flower, overlap one petal on top of the other by gluing it with a dot of hot glue  
 At this point join all the parts of the garland with hot glue as shown in the photo or at your convenience

